

# 2015 Calendar



Timber Home Living  
[timberhomeliving.com](http://timberhomeliving.com)

sponsored by



NEW ENERGY WORKS  
design | timberframing | woodworks  
[newenergyworks.com](http://newenergyworks.com)







# Great Lake Homestead



The third episode in a legacy project located on the high banks of Lake Erie, this house shares the view with a whimsical timber framed guest house, carriage house, and gazebo. Details include an open three story stair tower with central timber mast, custom steel spinner-head bolts and walnut inlay sheer keys in the reclaimed Douglas fir beams. **The exterior of this home is shown on the cover.**

**Size:** 4,069 sq. ft.

**Location:** Hamburg, NY

**Architect:** Charles Gordon Architecture & New Energy Works

716.839.6119 | [charlesgordonarchitecture.com](http://charlesgordonarchitecture.com)

**Fine Woodworking:** NEWwoodworks

585.289.4840 | [newwoodworks.com](http://newwoodworks.com)



**NEW ENERGY WORKS**  
design | timberframing | woodworks

[newenergyworks.com](http://newenergyworks.com)

SUNDAY	MONDAY	TUESDAY	WEDNESDAY	THURSDAY	FRIDAY	SATURDAY
	1	2	3	4	5	6
7  Pearl Harbor Remembrance Day	8	9	10	11	12	13
14	15	16  Hanukkah Begins at Sundown	17	18	19	20
21  First Day of Winter	22	23	24  Christmas Eve	25  Christmas Day	26  Boxing Day (Canada) Kwanzaa Begins	27
28	29	30	31  New Year's Eve	<b>Timber Home Living</b> <a href="http://timberhomeliving.com">timberhomeliving.com</a>		

Reclaimed American Gothic Walnut  
[pioneermillworks.com](http://pioneermillworks.com)

**2014**  
**December**







# A Model Of Steep Style



Surrounded on three sides by a reservoir, this family home will serve as a model for other custom timber frames in the area. Steeply pitched timber trusses unite the stylized exterior carports and the house itself. Below the king post trusses, a floating staircase of reclaimed Heart Pine and antique softwoods floors welcome visitors with warm tones and interesting history.

**Size:** 578 sq. ft. (Carport only)

**Location:** Woodbridge, VA

**Architect/Builder:** KohlMark Group  
703.764.1200 | [kohlmark.com](http://kohlmark.com)

**Reclaimed Wood:** Pioneer Millworks  
585.924.9970 | [pioniermillworks.com](http://pioniermillworks.com)

**Fine Woodworking:** NEWwoodworks  
585.289.4840 | [newwoodworks.com](http://newwoodworks.com)

 **NEW ENERGY WORKS**  
design | timberframing | woodworks  
[newenergyworks.com](http://newenergyworks.com)

SUNDAY	MONDAY	TUESDAY	WEDNESDAY	THURSDAY	FRIDAY	SATURDAY
				1  New Year's Day	2	3
4	5	6	7	8	9	10
11	12	13	14	15	16	17
18	19  Martin Luther King Jr. Day	20	21	22	23	24
25	26	27	28	29	30	31

Character Select Antique Heart Pine  
[pioniermillworks.com](http://pioniermillworks.com)

**2015**  
January







# Boat House Retreat



Nestled on the north end of a lake, this boathouse serves not only as a boat shelter but as a three season retreat and party space. It was also the inspiration for the family's timber frame home located just up the hill. Parallel chord Douglas fir trusses provide structure for a long clear span eliminating the need for numerous timber posts.

**Size:** 1,700 sq. ft.

**Location:** Skaneateles Lake, NY

**Architect:** Holmes King Kallquist & Associates, Architects

315.476.8371 | hkkarchitects.com

**Builder:** Kevin Rich Construction

315.685.0233



**NEW ENERGY WORKS**  
design | timberframing | woodworks

[newenergyworks.com](http://newenergyworks.com)

SUNDAY	MONDAY	TUESDAY	WEDNESDAY	THURSDAY	FRIDAY	SATURDAY
1	2 Groundhog Day	3	4	5	6	7
8	9	10	11	12	13	14 Valentine's Day
15	16 Presidents' Day	17	18 Ash Wednesday	19	20	21
22	23	24	25	26	27	28

**Timber Home Living**  
[timberhomeliving.com](http://timberhomeliving.com)

Reclaimed Rail Yard Oak  
[pioneermillworks.com](http://pioneermillworks.com)

**2015**  
**February**







# Gables With Curves



This new family home combines timber framing with traditional stick-building for the best of both worlds. The exterior gables are softened by warm-toned Cedar king post trusses with curved bottom chords. The truss design is mimicked in the great room and flows to a more intimate volume for the dining and entry spaces.

**Size:** 2,850 sq. ft.

**Location:** Boston, NY

**Architect:** Gerald Shaffer Architecture

716.742.8384

**Builder:** Paul Zerfas

716.560.6332



**NEW ENERGY WORKS**  
design | timberframing | woodworks

[newenergyworks.com](http://newenergyworks.com)

SUNDAY	MONDAY	TUESDAY	WEDNESDAY	THURSDAY	FRIDAY	SATURDAY
1	2	3	4 Purim Begins at Sundown	5	6	7
8 Daylight Saving Time Begins	9	10	11	12	13	14
15	16	17 St. Patrick's Day	18	19	20 First Day of Spring	21
22	23	24	25	26	27	28
29	30	31	<b>Timber Home Living</b> <a href="http://timberhomeliving.com">timberhomeliving.com</a>			

Reclaimed American Gothic Ash  
[pioneermillworks.com](http://pioneermillworks.com)

**2015**  
**March**







# A Walk In The Garden



Inspired by an existing arbor, the design for this pergola incorporated steep curves with intricate joinery. For each curve three pieces of reclaimed Western Red Cedar were half lapped and cut to shape. At 36 feet long, this is the centerpiece of the family garden, providing a relaxing walkway amongst a variety of colorful blooms.

**Location:** Rye, NY

**Landscape Architect:** Eric Moraillon

**Builder:** Hobbs, Inc

203.966.0726 | hobbsinc.com

**Reclaimed Wood:** Pioneer Millworks

585.924.9970 | pioneermillworks.com



**NEW ENERGY WORKS**  
design | timberframing | woodworks

[newenergyworks.com](http://newenergyworks.com)

SUNDAY	MONDAY	TUESDAY	WEDNESDAY	THURSDAY	FRIDAY	SATURDAY
			1	2	3 Passover Begins at Sundown Good Friday	4
5 Easter	6 Easter Monday (Canada)	7	8	9	10	11
12	13	14	15	16	17	18
19	20	21	22 Earth Day	23	24	25
26	27	28	29	30		

Reclaimed Weathered Teak  
[pioneermillworks.com](http://pioneermillworks.com)

**2015**  
April







# Accessible Comfort



This contemporary farmhouse's timber frame gives a nod to traditional barn-style homes common to rural upstate New York. An accessible home, the design allows the family to share a large common living space while meeting the needs of a handicapped child. The layout takes advantage of the southern exposure and pastoral views into the surrounding valley.

**Size:** 4,627 sq. ft.

**Location:** Mount Vision, NY

**Architect/Builder:** New Energy Works  
585.924.3860 | [newenergyworks.com](http://newenergyworks.com)

**Fine Woodworking:** NEWwoodworks  
585.289.4840 | [newwoodworks.com](http://newwoodworks.com)



**NEW ENERGY WORKS**  
design | timberframing | woodworks  
[newenergyworks.com](http://newenergyworks.com)

SUNDAY

MONDAY

TUESDAY

WEDNESDAY

THURSDAY

FRIDAY

SATURDAY

Timber Home Living  
[timberhomeliving.com](http://timberhomeliving.com)

					1	2
3	4	5	6	7	8	9
10	11	12	13	14	15	16
Mother's Day						Armed Forces Day
17	18	19	20	21	22	23
	Victoria Day (Canada)					
24	25	26	27	28	29	30
31	Memorial Day					

Settlers' Plank Mixed Hardwoods  
[pioneermillworks.com](http://pioneermillworks.com)

2015  
May







# Gentleman's Barn



Barns are often multi-purpose spaces and this Michigan timber frame certainly fits that bill. While the barn stables two horses, it also houses Mike's class MG Midget, custom wood shop, his large bee keeping operation (they produce about 300 lbs of honey each season!), and guest quarters in the loft space. Family gatherings and large parties are a common occurrence, often punctuated by west Michigan sunsets seen from the barn bay.

**Size:** 1,586 sq. ft.

**Location:** Glenn, MI

**Architect:** Christopher Dietrich AIA

**Builder:** Darpel and Assoc. Builders Inc  
269.561.4679 | [darpelandassociates.com](http://darpelandassociates.com)



**NEW ENERGY WORKS**  
design | timberframing | woodworks  
[newenergyworks.com](http://newenergyworks.com)

SUNDAY	MONDAY	TUESDAY	WEDNESDAY	THURSDAY	FRIDAY	SATURDAY
	1	2	3	4	5	6
7	8	9	10	11	12	13
14	15	16	17	18	19	20
Flag Day						
21	22	23	24	25	26	27
Father's Day First Day of Summer			St. John Baptiste Day (Canada)			
28	29	30	<b>Timber Home Living</b> <a href="http://timberhomeliving.com">timberhomeliving.com</a>			

Grandma's Attic Mixed Softwoods  
[pioneermillworks.com](http://pioneermillworks.com)

**2015**  
*June*







# Sweet Repose



Designed to accommodate a steep build site, this family retreat includes a finished lower level walkout and large screened porch for outdoor dining and entertainment. The modest footprint allows single level living with three en suite bedrooms and a generous family room. The timber work within the home brings the warmth of wood while keeping with the very contemporary lines.

**Size:** 2,740 sq. ft.

**Location:** Greenville, SC

**Architect:** Turkel Design, LLC  
518.695.3560 | turkeldesign.com

**Builder:** Dillard-Jones Builders  
864.527.0463 | dillardjones.com

**Engineer:** Fire Tower Engineered Timber  
401.654.4600 | ftet.biz



**NEW ENERGY WORKS**  
design | timberframing | woodworks

[newenergyworks.com](http://newenergyworks.com)

SUNDAY

MONDAY

TUESDAY

WEDNESDAY

THURSDAY

FRIDAY

SATURDAY

Timber Home Living  
timberhomeliving.com

Canada Day  
(Canada)

Independence Day

5

6

7

8

9

10

11

12

13

14

15

16

17

18

19

20

21

22

23

24

25

26

27

28

29

30

31

Reclaimed Settlers' Plank Oak  
[pionermillworks.com](http://pionermillworks.com)

2015  
July







# Reclaimed & Renewed



After we constructed a quaint stone addition to house a private boutique winery, the owner of this homestead overlooking Keuka Lake decided it was time to renovate the original barn. An interior industrial salvaged timber frame is complemented with the use of steel to create bowstring trusses. Barrel stave oak stairs with functional steel connections lead to the loft office that extends up to a widow's watch, giving the wine maker fine views of the vineyard and lake.

**Size:** 1,560 sq. ft.

**Location:** Keuka Lake, NY

**Architect/Builder:** New Energy Works  
585.924.3860 | [newenergyworks.com](http://newenergyworks.com)

**Reclaimed Wood:** Pioneer Millworks  
585.924.9970 | [pionermillworks.com](http://pionermillworks.com)

**Fine Woodworking:** NEWwoodworks  
585.289.4840 | [newwoodworks.com](http://newwoodworks.com)



**NEW ENERGY WORKS**  
design | timberframing | woodworks

[newenergyworks.com](http://newenergyworks.com)

SUNDAY

MONDAY

TUESDAY

WEDNESDAY

THURSDAY

FRIDAY

SATURDAY

Timber Home Living  
[timberhomeliving.com](http://timberhomeliving.com)

2

3

4

5

6

7

8

9

10

11

12

13

14

15

16

17

18

19

20

21

22

23

24

25

26

27

28

29

30

31

Hand-Hewn Hardwood Timbers  
[pionermillworks.com](http://pionermillworks.com)

2015  
August







# Street Of Dreams



Eleven homes were constructed for Oregon's 'Street of Dreams' and then judged by viewers and professionals. This couple's home included great room, porch, and master bedroom timber trusses emboldened with a chamfered edge and dark stain. Congratulations to Dave and Nancy as their highly crafted home took Best of Show!

**Size:** 5,350 sq. ft.

**Location:** West Linn, OR

**Architect:** Tolstedt Architects

406.522.0718 | [tolstedtarchitects.com](http://tolstedtarchitects.com)

**Developer:** Elite Development Northwest

503.860.3014 | [ednorthwest.com](http://ednorthwest.com)



**NEW ENERGY WORKS**  
design | timberframing | woodworks

[newenergyworks.com](http://newenergyworks.com)

SUNDAY	MONDAY	TUESDAY	WEDNESDAY	THURSDAY	FRIDAY	SATURDAY
		1	2	3	4	5
6	7 Labor Day	8	9	10	11 Patriot Day	12
13 Grandparent's Day Rosh Hashanah Begins at Sundown	14	15	16	17	18	19
20	21	22 Yom Kippur Begins at Sundown	23 First Day of Autumn	24	25	26
27	28	29	30			

Reclaimed American Gothic Beech/Maple  
[pioneermillworks.com](http://pioneermillworks.com)

**2015**  
September







# Lakeside Living



Vanessa spent summers with her family as a kid at a home on this site. She and Paul bought the property to build their new family vacation home. The house capitalizes on the steep slope of the site, providing multiple points of entry, panoramic lake views, and expansive deck. The upper level of the home has timber bunks that provide unique views of the lake as occupants can "lay" in the windows.

**Size:** 1,616 sq. ft.

**Location:** Keuka Park, NY

**Architect/Builder:** New Energy Works

585.924.3860 | [newenergyworks.com](http://newenergyworks.com)

**Reclaimed Wood:** Pioneer Millworks

585.924.9970 | [pionermillworks.com](http://pionermillworks.com)

**Fine Woodworking:** NEWwoodworks

585.289.4840 | [newwoodworks.com](http://newwoodworks.com)



**NEW ENERGY WORKS**  
design | timberframing | woodworks

[newenergyworks.com](http://newenergyworks.com)

SUNDAY

MONDAY

TUESDAY

WEDNESDAY

THURSDAY

FRIDAY

SATURDAY

<div> <div>Timber Home Living</div> <div>timberhomeliving.com</div> </div>				1	2	3
4	5	6	7	8	9	10
11	12 Columbus Day Thanksgiving Day (Canada)	13	14	15	16	17
18	19	20	21	22	23	24
25	26	27	28	29	30	31 Halloween

Reclaimed Barn Siding  
[pionermillworks.com](http://pionermillworks.com)

**2015**  
October







# Lake Living In The Finger Lakes



Located in a small town in the Finger Lakes Region of western NY, this home offers a graceful vernacular with steeply curved trusses and split posts. The frame juxtaposes vaulted, soft curved forms against the hard lines of the structure.

**Size:** 4,821 sq. ft.

**Location:** Skaneateles, NY

**Architect:** Holmes King Kallquist & Associates, Architects

315.476.8371 | [hkkarchitects.com](http://hkkarchitects.com)

**Builder:** Kevin Rich Construction

315.685.0233



**NEW ENERGY WORKS**  
design | timberframing | woodworks

[newenergyworks.com](http://newenergyworks.com)

SUNDAY	MONDAY	TUESDAY	WEDNESDAY	THURSDAY	FRIDAY	SATURDAY
1  Daylight Saving Time Ends	2	3	4	5	6	7
8	9	10	11  Veteran's Day Remembrance Day (Canada)	12	13	14
15	16	17	18	19	20	21
22	23	24	25	26  Thanksgiving Day	27	28
29	30	<b>Timber Home Living</b> <a href="http://timberhomeliving.com">timberhomeliving.com</a>				

Black & Tan Oak 50/50  
[pioneermillworks.com](http://pioneermillworks.com)

**2015**  
**November**







# Equestrian Elegance



Timber, copper, steel, and stonework come together to bring functionality and elegance to this private farm. The clerestory, which runs the length of the barn, allows natural light into the equestrian complex. The stabling area and indoor arena benefit from the time-tested timber construction, while providing a more natural and relaxing environment for the equine inhabitants.

**Size:** Barn – 8,315 sq ft  
Indoor Arena – 22,650 sq ft

**Location:** Waltham, MA

**Architects:** Marcus Gleysteen Architects  
617.542.6060 | [gleysteendesign.com](http://gleysteendesign.com)  
Blackburn Architects, P.C.  
202.337.1755 | [blackburnarch.com](http://blackburnarch.com)

**Builder:** Kenneth Vona Construction, Inc.  
781.890.5599 | [kenvona.com](http://kenvona.com)

 **NEW ENERGY WORKS**  
design | timberframing | woodworks  
[newenergyworks.com](http://newenergyworks.com)

SUNDAY	MONDAY	TUESDAY	WEDNESDAY	THURSDAY	FRIDAY	SATURDAY
		1	2	3	4	5
6  Hanukkah Begins at Sundown	7  Pearl Harbor Remembrance Day	8	9	10	11	12
13	14	15	16	17	18	19
20	21	22  First Day of Winter	23	24  Christmas Eve	25  Christmas Day	26  Boxing Day (Canada) Kwanzaa Begins
27	28	29	30	31  New Year's Eve	<b>Timber Home Living</b> <a href="http://timberhomeliving.com">timberhomeliving.com</a>	

Reclaimed American Gothic Oak  
[pioneermillworks.com](http://pioneermillworks.com)

**2015**  
**December**



# DESIGNING & BUILDING YOUR HOME

We haven't yet met two clients who are exactly alike. You are different than anyone else. Your dream becomes reality with the combination of your site, your budget, your needs and goals, epitomized in your home's design and handcrafted timber frame, completed with your construction partners.

At New Energy Works, we remain committed to very personal and custom home design. We work with super architects and designers all over the country. These partners have brought us new ideas, different backgrounds, and great clients we wouldn't otherwise have met. We love this collaboration.

Alternatively, for those who prefer a more consolidated, one-stop approach, we have an in-house architectural design department. We keep our architects' desks sandwiched between our engineers, who have to make the frame design work, and construction managers, who have to build the finished design.

Once the design and engineering documents for your project are complete, construction can begin. Whether we act as your general contractor or not, our construction

vanities, and cabinetry – should complement your frame. This is why our own fine woodworking group, NEWwoodworks, came to be. Our craftsmen understand how to help tell the story of your frame with a balance of texture, design, and high craft.

Here's a toast to you and your differences, and your amazing projects.

## NEWwoodworks

If you're the kind of person who feels investing in a custom home is not just a matter of style but a statement about your values, then you are probably already thinking about the effect your cabinetry, stairs, doors and furniture can have on the overall quality of the project.

*“ We liken timber framing to ‘furniture you live in’ and we’ve found that it is best complemented with fine crafted woodworking. ”*

So it was that NEWwoodworks, our fine woodworking group was established. Now well into their second decade, this group is 16 people strong with a 15,000 sq. ft. wood shop, and a dossier of clients that reaches outside the realm of timber

Architect: Holmes King Kallquist & Assoc., Arch, Photo © Don Cochran Photography





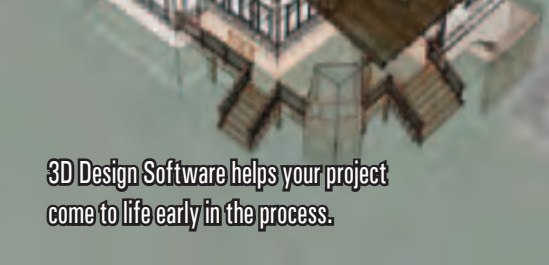

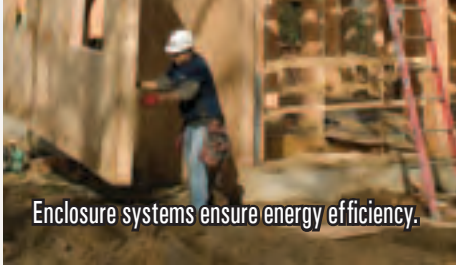

3D Design Software helps your project come to life early in the process.



Enclosure systems ensure energy efficiency.



Timbers and joinery are precision cut using CNC technology.



Joinery is hand finished and fitted by experienced craftsmen.



Raising day is a celebration of craft and shelter.

group is a special part of who we are, building a select number of jaw-dropping projects every year. The information they accrue during the completion of a home provides valuable feedback to our designers, engineers, and timber framers.

Raising day is a celebratory occasion, the culmination of months of collaborative effort. We believe each project is best served when *the craftsmen who cut your frame also raise it*, bringing their knowledge and timber framing experience to the site.

Once your frame is up, enclosure becomes the next priority. Our construction group, the same guys who put together the thousands of separate components of a finished house, are also available to handle your enclosure system, and can provide you with walls and a roof in a matter of days after the raising using our Matrix Wall™ enclosure system or Structural Insulated Panels (SIPs). The completed enclosure allows you and your general contractor to install the roof and have a dry structure ready for windows, doors, and the beginning of interior work.

Functional elements in your kitchen, bathrooms, and great room are really the finishing touches for your dream project. We believe timber framing is sculpture you live in and those elements – stairs, doors,

framing, a community that includes gifted builders, design professionals, and clients across the nation. Our interior woodworking results from skilled hands, digital and CNC technology, and good-old-fashioned creativity.

- Cabinetry
- Stairs
- Doors
- Furniture

Visit [newwoodworks.com](http://newwoodworks.com) or call **585.289.4840** for more information





# Reclaimed Wood

## Modern + Traditional

25 years ago part of our original shop collapsed under a wet spring snow. As we were digging out, an English couple we were building a cabin for asked if we would re-use the fallen timbers for their project. It was an intriguing request that eventually lead us to reclaimed wood as a viable and amazing timber source. It was an epiphany from which our sister company, Pioneer Millworks, was born.

Fast forward to today and Pioneer Millworks is one of the most recognized reclaimed wood companies in the world. Their structural and decorative timbers, flooring, paneling, and custom wood products are used in fine and funky shops, hotels, restaurants, and homes around the globe. The wood is sourced from industrial buildings, canal locks, bridges, food and wine industry, and agricultural buildings. The old growth trees cut over a hundred years ago to build these various structures offer superior stability and rich patinas.

Decades of working with this traditional building material has shown it to be unmatched for design flexibility, sustainability, and in the case of reclaimed wood, history and character. Timber surface treatments include smooth, rough-sawn, hand-hewn, wire-brushed, and more. Original mortise pockets, bolt and nail holes, ferrous staining, and deep color are common and celebrated characteristics of reclaimed timbers.

Reclaimed solid and engineered wood products are fully manufactured — from sourcing, to milling, to you — in the USA from Pioneer Millworks NY and OR facilities.

[pionermillworks.com](http://pionermillworks.com) | 800.951.WOOD



**LEFT** Industrial salvaged timbers  
**MIDDLE** Reclaimed timbers, ceiling  
T&G, flooring, and cabinetry **BOTTOM**  
**LEFT** Reclaimed timber joinery **BOTTOM**  
**RIGHT** Reclaimed Mixed Gray Barn Siding





# ENERGY EFFICIENT ENCLOSURES

We've often said that enclosing our timber frames is like "throwing a blanket over a piece of furniture," where the woodwork and structure is cozy and protected within, and the weather is kept out. This is certainly one of timber framing's most practical benefits.



## Structural Insulated Panels (SIPs) & the Matrix Wall™

SIPs are the workhorses of the industry, and we've installed over a million square feet. The 12" roof panel is made of expanded polystyrene sandwiched between sheathing and offers an unbroken layer of R-50 insulation. Its ability to span between timber rafters and even create the overhang makes SIPs a good choice.

On the sidewalls, we either use SIPs or our Matrix Wall system of 2x6 studs filled with cellulose insulation, sheathing, 1 1/2" of rigid insulation and strapping. Both work great, and we'll share with you why one or the other might be best for your home.

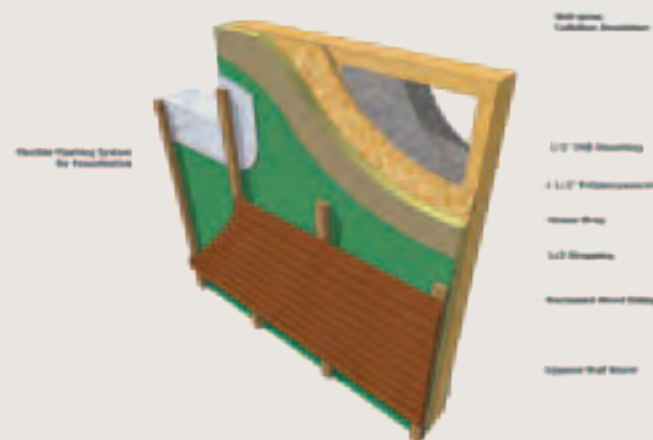

## Enclose & Test

We are General Contractors on a few projects each year in the Finger Lakes, near our Farmington shop. This has allowed us to continue to develop our craft, and our construction systems. We now offer our Enclose and Test™ service, where we apply the outer walls and roof, install the windows, and use the most advanced housewraps, tapes and sealants to insure a tight, long lasting shell. We then perform a Blower Door test that will show any areas of leaks and give you a solid benchmark of energy efficiency as the project moves towards completion.

Our Building Information Modeling program can show you what savings you can expect, and where best to spend your homebuilding budget to maximize the return. Our goal with the Enclose and Test service is to help you project get started right, in an efficient and effective way.

## Timber Home Living

To subscribe to  
Timber Home Living magazine,  
call 800-234-8496.



For dates and locations to  
The Log & Timber Home Show and University,  
visit [loghome.com/shows](http://loghome.com/shows).



## NEW ENERGY WORKS

design | timberframing | woodworks

**Headquarters** 585.924.3860  
[joinery@newenergyworks.com](mailto:joinery@newenergyworks.com)

**West Coast** 503.719.4800  
[studio@newenergyworks.com](mailto:studio@newenergyworks.com)

**New England** 802.310.3546  
[mikeb@newenergyworks.com](mailto:mikeb@newenergyworks.com)

**Midwest** 734.996.2600  
[drake@newenergyworks.com](mailto:drake@newenergyworks.com)

See our Postcard of the Day here:  
[newenergyworks.com/postcards](http://newenergyworks.com/postcards)

**800.486.0661**  
[newenergyworks.com](http://newenergyworks.com)



# Our

The very best relationships are founded on the basis of openness and honesty. Here's a snapshot of New Energy Works Timberframers.

We opened our doors in New York in 1982, and in Oregon in 2008, with the idea of creating beautiful, energy efficient shelters. Now, thirty years later, we continue to be impressed with the passion our clients bring to the design and build process. Our enthusiasm for joinery remains unabated and we're still moved by the sight of a naked frame against the sky. We've witnessed aspects of our craft change significantly over the years. We're pleased to be at the cutting edge of our chosen profession, utilizing advances such as computer assisted design, 3D modeling, and CNC-cut joinery, yet retaining a level of Old World craftsmanship and sustainable building methods that speak to us all.

We have long believed in the "triple bottom line" approach to business, where People, Planet and Profit all play equal roles in our decision making and our relationships. During the recession we maintained wages and benefits, kept our **Made in the US** credo and use of natural and local products where applicable. We accept our role as community partners and believe we will do well if we do good. Kevin Ireton, at the time the editor of Fine Homebuilding magazine, wrote that we were "one of the greenest companies I know."

**East Coast Shop**  
1180 Commercial Drive, Farmington, NY 14425



# Story

Today, along with our sister company, Pioneer Millworks, we employ nearly 100 designers, timberwrights, engineers, craftspeople, and community members. Together we design and build some of the most lyrical and efficient timber frames in the industry, using reclaimed timbers, environmentally responsible practices, and state-of-the-art technology.

On the commercial side, our knack for the 'big and difficult' has seen us collaborate on a number of award-winning public buildings including visitors centers, museums, zoos, retail stores, conference facilities, and offices. We welcome the opportunity to work with architects and developers. We use design and engineering software compatible with most others in the field. We pride ourselves on the level of service we offer and the rapidity with which we're able to produce accurate models and estimates.

Building a dream home is a journey, one we're always excited to take with you, offering our experience and expertise along the way.

—New Energy Works Timberframers



**NEW ENERGY WORKS**  
design | timberframing | woodworks

**West Coast Shop**  
2675 NE Orchard Ave, McMinnville, OR 97128